

**2011 REAPPRAISAL
ECONOMIC AREA 1
VACANT LAND
MEADOW/TREE LAND STUDY**

07/01/2006-06/30/2010

ACRES	LEA	VALUE
0.0 - 0.89	11880	\$54,000
0.9 - 2.0	11890	\$69,400
2.01 - 4.0	11900	\$86,100
4.01 - 6.0	11910	\$97,600
6.01 - 8.0	11920	\$106,700
8.01 - 10.0	11930	\$114,400
10.01 - 12.0	11940	\$121,100
12.01 - 14.0	11950	\$127,000
14.01 - 16.0	11960	\$132,400
16.01 - 18.0	11970	\$137,300
18.01 - 20.0	11980	\$141,900
20.01 - 22.0	11990	\$146,200
22.01 - 24.0	12000	\$150,200
24.01 - 26.0	12010	\$154,000
26.01 - 28.0	12020	\$157,500
28.01 - 30.0	12030	\$161,000
30.01 - 32.0	12040	\$164,200
32.01 - 34.0	12050	\$167,300
34.01 - 36.0	12060	\$170,300
36.01+	12070	\$4,700 PER ACRE

THESE VALUES ARE BASED ON THE FOLLOWING GRAPH

**2011 REAPPRAISAL
ECONOMIC AREA 1
VACANT LAND
MEADOW/TREE LAND STUDY**

07/01/2006-06/30/2010

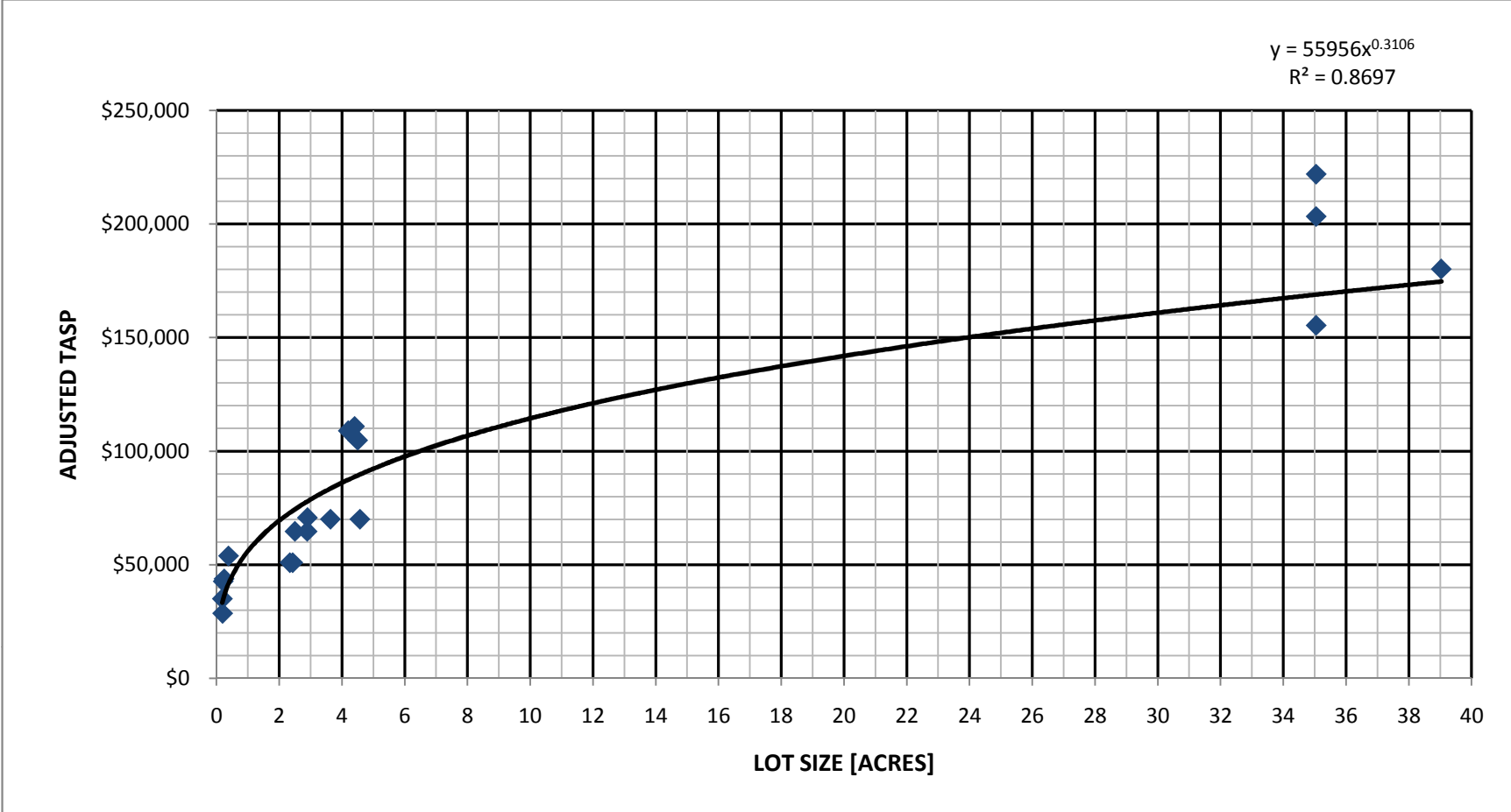

THE VALUE (**ADJUSTED TASP**) AND SIZE (**ACRES**) FROM THE FOLLOWING SALES WERE PLOTTED ON THIS GRAPH

**2011 REAPPRAISAL
ECONOMIC AREA 1
VACANT LAND
MEADOW/TREE LAND STUDY**

07/01/2006-06/30/2010

ACCOUNT NUMBER	SALE DATE	SALE PRICE	TIME ADJUSTED SALE PRICE	ADJUSTED TASP	ACRES	PARCEL NUMBER	LEGAL
R045048	01/16/2008	\$70,000	\$54,775	\$35,056	0.187	370113014006	LOT 6 THORNTON MEADOWS #581655
R044384	05/18/2010	\$45,000	\$44,662	\$28,584	0.194	378703411001	LOT 1 ROSE HIP SUBDIVISION #598501
R045046	01/16/2008	\$85,000	\$66,512	\$42,658	0.211	370113014004	LOT 4 THORNTON MEADOWS #581643
R045050	04/09/2008	\$85,000	\$68,425	\$43,792	0.243	370113014008	LOT 8 THORNTON MEADOWS #583213
R045054	09/02/2008	\$100,000	\$84,250	\$53,920	0.383	370113014012	LOT 12 THORNTON MEADOWS #586217
R044313	09/15/2008	\$94,500	\$79,616	\$50,954	2.340	370114008010	LOT 10 HORSE MEADOWS SUBDIVISION #586494
R044304	09/15/2008	\$94,500	\$79,616	\$50,954	2.430	370114008001	LOT 1 HORSE MEADOWS SUBDIVISION #586496
R044305	09/17/2008	\$120,000	\$101,100	\$64,704	2.500	370114008002	LOT 2 HORSE MEADOWS SUBDIVISION #586546
R044310	09/17/2008	\$120,000	\$101,100	\$64,704	2.890	370114008007	LOT 7 HORSE MEADOWS SUBDIVISION #586548
R044312	10/29/2008	\$130,000	\$110,500	\$70,720	2.900	370114008009	LOT 9 HORSE MEADOWS SUBDIVISION #587355
R044307	09/15/2008	\$130,000	\$109,525	\$70,096	3.630	370114008004	LOT 4 HORSE MEADOWS SUBDIVISION #586493
R043143	08/11/2006	\$260,000	\$170,300	\$108,992	4.200	370114007003	LOT 3 FOX MEADOWS SUBDIVISION #567928
R043145	03/27/2007	\$245,000	\$173,338	\$110,936	4.400	370114007005	LOT 5 FOX MEADOWS SUBDIVISION #574592
R043144	08/04/2006	\$250,000	\$163,750	\$104,800	4.500	370114007004	LOT 4 FOX MEADOWS SUBDIVISION #567738
R044306	09/15/2008	\$130,000	\$109,525	\$70,096	4.570	370114008003	LOT 3 HORSE MEADOWS SUBDIVISION #586495
R042749	07/28/2006	\$375,000	\$242,812	\$155,399	35.050	370100005013	LOT 4 HORSE RIVER RANCH SUBD #567447
R042748	03/12/2010	\$325,000	\$317,688	\$203,320	35.050	370100005012	LOT 5 HORSE RIVER RANCH SUBD #597401
R042744	04/03/2007	\$485,000	\$346,775	\$221,936	35.050	370100005002	LOT 8 HORSE RIVER RANCH SUBD #574183
R042752	09/13/2006	\$425,000	\$281,563	\$180,200	39.038	370100005004	LOT 17 HORSE RIVER RANCH SUBD #569040