

2011 REAPPRAISAL
ECONOMIC AREA 6
VACANT LAND
SAGE LAND STUDY

07/01/2006-06/30/2010

SAGE UPPER: 60000
SAGE LOWER: 60030
\$5,363/ACRE

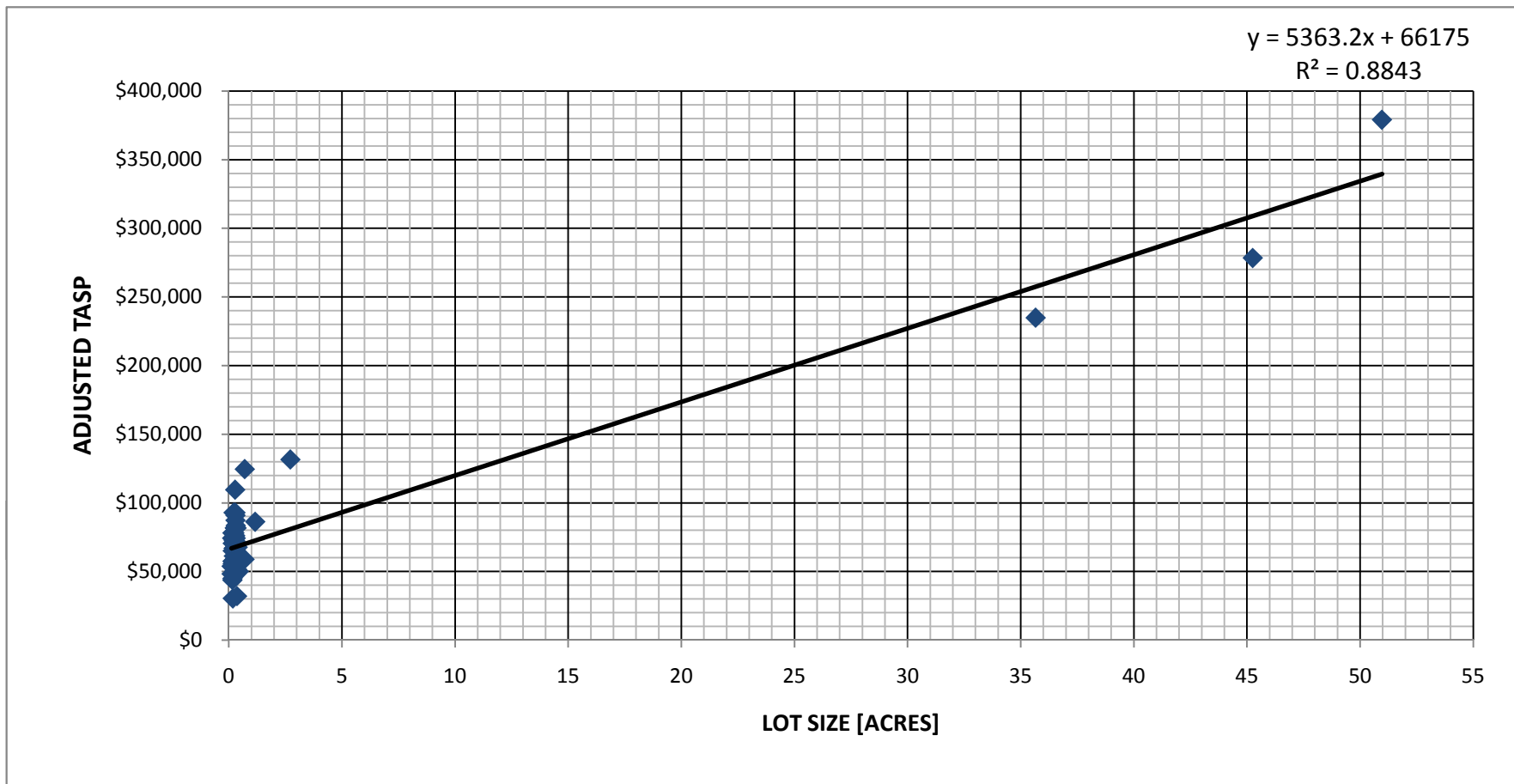

**2011 REAPPRAISAL
ECONOMIC AREA 6
VACANT LAND
SAGE LAND STUDY**

07/01/2006-06/30/2010

ACCOUNT NUMBER	SALE DATE	ADJUSTED SALE PRICE	TIME ADJUSTED SALE PRICE	ADJUSTED TASP (TASP X 0.64)	ACRES	SQUARE FEET	PARCEL NUMBER	LEGAL
R042587	01/22/2007	\$130,000	\$75,400	\$48,300	0.120	5,227	325707407020	LOT M2-47 BUCKHORN RANCH FILING 2B #572585
R042588	09/27/2007	\$145,000	\$84,100	\$53,800	0.120	5,227	325707407021	LOT M2-48 BUCKHORN RANCH FILING 2B #579181
R042576	05/01/2009	\$150,000	\$115,875	\$74,200	0.140	6,098	325707407009	LOT M2-18 BUCKHORN RANCH FILING 2B #599610
R042665	03/22/2010	\$72,000	\$68,220	\$43,700	0.160	6,970	325707416005	LOT M3-37 BUCKHORN RANCH FILING 2B #597595
R042675	11/25/2008	\$105,000	\$70,088	\$44,900	0.160	6,970	325707417003	LOT M3-50 BUCKHORN RANCH FILING 2B #587832
R043928	09/12/2006	\$210,000	\$121,800	\$78,000	0.160	6,970	325707405010	LOT M2-29 BUCKHORN RANCH FILING 2B #568971
R044090	09/15/2006	\$150,000	\$87,000	\$55,700	0.170	7,394	325512034018	LOT S7 LARKSPUR SUBDIVISION #569119
R042589	03/04/2010	\$50,000	\$47,375	\$30,300	0.170	7,405	325707407022	LOT M2-49 BUCKHORN RANCH FILING 2B #597262
R042637	07/10/2007	\$145,000	\$84,100	\$53,800	0.170	7,405	325707414003	LOT M3-25 BUCKHORN RANCH FILING 2B #576931
R042669	11/06/2006	\$155,000	\$89,900	\$57,500	0.170	7,405	325707416009	LOT M3-35 BUCKHORN RANCH FILING 2B #575931
R042648	10/16/2007	\$155,000	\$89,900	\$57,500	0.170	7,405	325707415005	LOT M3-24 BUCKHORN RANCH FILING 2B #579792
R042632	01/09/2007	\$175,000	\$101,500	\$65,000	0.170	7,405	325707413008	LOT M3-12 BUCKHORN RANCH FILING 2B #572256
R042559	08/30/2007	\$190,000	\$110,200	\$70,500	0.170	7,405	325707405001	LOT M2-28 BUCKHORN RANCH FILING 2B #578391
R044094	07/30/2008	\$125,000	\$74,688	\$47,800	0.205	8,943	325512034022	LOT S10 LARKSPUR SUBDIVISION #587326
R044097	03/22/2007	\$250,000	\$145,000	\$92,800	0.209	9,114	325512034025	LOT S12 LARKSPUR SUBDIVISION #574014
R044086	09/15/2006	\$180,000	\$104,400	\$66,800	0.217	9,435	325512034014	LOT S5 LARKSPUR SUBDIVISION #569371
R044091	09/15/2006	\$165,000	\$95,700	\$61,200	0.218	9,499	325512034019	LOT S8 LARKSPUR SUBDIVISION #569278
R044082	09/21/2006	\$180,000	\$104,400	\$66,800	0.219	9,559	325512034010	LOT S3 LARKSPUR SUBDIVISION #569365
R044080	10/19/2006	\$195,000	\$113,100	\$72,400	0.220	9,598	325512034008	LOT S2 LARKSPUR SUBDIVISION #575732
R044084	10/06/2006	\$175,000	\$101,500	\$65,000	0.227	9,900	325512034012	LOT S4 LARKSPUR SUBDIVISION #569889
R044093	09/20/2006	\$180,000	\$104,400	\$66,800	0.237	10,318	325512034021	LOT S9 LARKSPUR SUBDIVISION #569369
R044074	09/15/2006	\$195,000	\$113,100	\$72,400	0.238	10,375	325512034002	LOT S1 LARKSPUR SUBDIVISION #569057
R044104	09/26/2006	\$210,000	\$121,800	\$78,000	0.243	10,590	325512034032	LOT S19 LARKSPUR SUBDIVISION #600129
R044100	11/03/2006	\$220,000	\$127,600	\$81,700	0.267	11,614	325512034028	LOT S15 LARKSPUR SUBDIVISION #570645
R044099	11/03/2006	\$220,000	\$127,600	\$81,700	0.267	11,652	325512034027	LOT S14 LARKSPUR SUBDIVISION #570641
R044102	09/18/2006	\$195,000	\$113,100	\$72,400	0.270	11,745	325512034030	LOT S17 LARKSPUR SUBDIVISION #569364
R044117	08/07/2008	\$150,000	\$92,250	\$59,000	0.275	11,973	325512034045	LOT S32 LARKSPUR SUBDIVISION #585682
R044112	07/25/2008	\$150,000	\$89,625	\$57,400	0.276	12,032	325512034040	LOT S27 LARKSPUR SUBDIVISION #585407 #598027
R044089	12/04/2006	\$205,000	\$118,900	\$76,100	0.277	12,071	325512034017	LOT S6 LARKSPUR SUBDIVISION #571401
R044116	02/28/2008	\$295,000	\$171,100	\$109,500	0.278	12,102	325512034044	LOT S31 LARKSPUR SUBDIVISION #582393

**2011 REAPPRAISAL
ECONOMIC AREA 6
VACANT LAND
SAGE LAND STUDY**

07/01/2006-06/30/2010

ACCOUNT NUMBER	SALE DATE	ADJUSTED SALE PRICE	TIME ADJUSTED SALE PRICE	ADJUSTED TASP (TASP X 0.64)	ACRES	SQUARE FEET	PARCEL NUMBER	LEGAL
R044103	12/08/2006	\$190,000	\$110,200	\$70,500	0.284	12,387	325512034031	LOT S18 LARKSPUR SUBDIVISION #574357
R044096	02/22/2007	\$165,000	\$95,700	\$57,400	0.285	12,410	325512034024	LOT S11 LARKSPUR SUBDIVISION #574442
R044113	08/07/2008	\$150,000	\$92,250	\$59,000	0.285	12,432	325512034041	LOT S28 LARKSPUR SUBDIVISION #585681
R044114	07/31/2008	\$150,000	\$89,625	\$57,400	0.286	12,447	325512034042	LOT S29 LARKSPUR SUBDIVISION #585566
R044115	07/31/2008	\$150,000	\$89,625	\$57,400	0.286	12,461	325512034043	LOT S30 LARKSPUR SUBDIVISION #585567
R044109	01/23/2007	\$245,000	\$142,100	\$90,900	0.287	12,519	325512034037	LOT S24 LARKSPUR SUBDIVISION #572479
R044110	09/14/2006	\$250,000	\$145,000	\$92,800	0.287	12,519	325512034038	LOT S25 LARKSPUR SUBDIVISION #569941
R044101	11/03/2006	\$235,000	\$136,300	\$87,200	0.293	12,764	325512034029	LOT S16 LARKSPUR SUBDIVISION #570646
R044107	09/14/2006	\$175,000	\$101,500	\$65,000	0.298	12,983	325512034035	LOT S22 LARKSPUR SUBDIVISION #569038 #597305
R044098	09/18/2006	\$225,000	\$130,500	\$83,500	0.301	13,125	325512034026	LOT S13 LARKSPUR SUBDIVISION #569277
R044105	10/03/2006	\$200,000	\$116,000	\$74,200	0.302	13,175	325512034033	LOT S20 LARKSPUR SUBDIVISION #569720
R014997	11/21/2007	\$130,000	\$93,600	\$59,900	0.310	13,504	325721404012	LOT 17 BLK 21 CRESTED BUTTE SOUTH FILING 3 #580506
R044111	07/25/2008	\$150,000	\$89,625	\$57,400	0.324	14,123	325512034039	LOT S26 LARKSPUR SUBDIVISION #585406
R044108	11/21/2006	\$220,000	\$127,600	\$81,700	0.336	14,620	325512034036	LOT S23 LARKSPUR SUBDIVISION #571139
R027097	08/30/2006	\$192,000	\$80,640	\$51,600	0.350	15,246	325722304050	LOT 41 BLK 23 CRESTED BUTTE SOUTH FILING 3 #568717
R044996	07/06/2009	\$50,000	\$50,000	\$32,000	0.360	15,682	325722202065	LOT 12 BLK 28 CRESTED BUTTE SOUTH FILING 4 #591877
R044106	11/02/2006	\$190,000	\$110,200	\$70,500	0.370	16,120	325512034034	LOT S21 LARKSPUR SUBDIVISION #570642
R015111	07/26/2007	\$165,000	\$105,600	\$67,600	0.390	16,988	325722304023	LOT 2 BLK 23 CRESTED BUTTE SOUTH FILING 3 #577490
R031390	06/24/2008	\$99,500	\$85,570	\$54,800	0.400	17,424	325722304046	LOT 13 BLK 23 CRESTED BUTTE SOUTH FILING 3 #584843
R043830	07/11/2006	\$195,000	\$78,000	\$50,000	0.440	19,166	325722202058	LOT 35 BLK 28 CRESTED BUTTE SOUTH FILING 4 #566833
R042538	02/26/2010	\$99,000	\$92,070	\$58,900	0.690	30,056	325707016001	LOT 25 BUCKHORN RANCH FILING 2B #597314
R042698	05/15/2009	\$252,000	\$194,670	\$124,600	0.700	30,492	325708003001	LOT 33 BUCKHORN RANCH FILING 2B #591578
R042686	07/20/2007	\$232,200	\$134,676	\$86,200	1.160	50,530	325708001003	LOT 101 BUCKHORN RANCH FILING 2B #577244
R040934	03/21/2007	\$354,500	\$205,610	\$131,600	2.716	118,309	325707004004	LOT 4 WHETSTONE VISTA #573941
R027593	01/11/2007	\$405,000	\$234,900	\$234,900	35.660	1,553,350	343300002010	TRACT 8 ROARING JUDY PHASE II #572370
R027497	09/22/2006	\$480,000	\$278,400	\$278,400	45.260	1,971,526	343300002006	TRACT 9 ROARING JUDY RANCH PHASE II #569532
R030078	09/23/2009	\$450,000	\$379,125	\$379,125	50.970	2,220,253	343500002004	GOSS TRACT, ROUND MOUNTAIN AT ROARING JUDY RANCH #594195