

2011 REAPPRAISAL  
ECONOMIC AREA 8  
VACANT LAND

MEADOW/TREE LAND STUDY: GOOD ACCESS

07/01/2006-06/30/2010

NONRIVER ALMONT: 80130 (COMP)  
MEADOW/TREE GOOD ACCESS: 80070  
MEADOW/TREE GOOD ACCESS MIXED: 80071  
\$4,086/ACRE

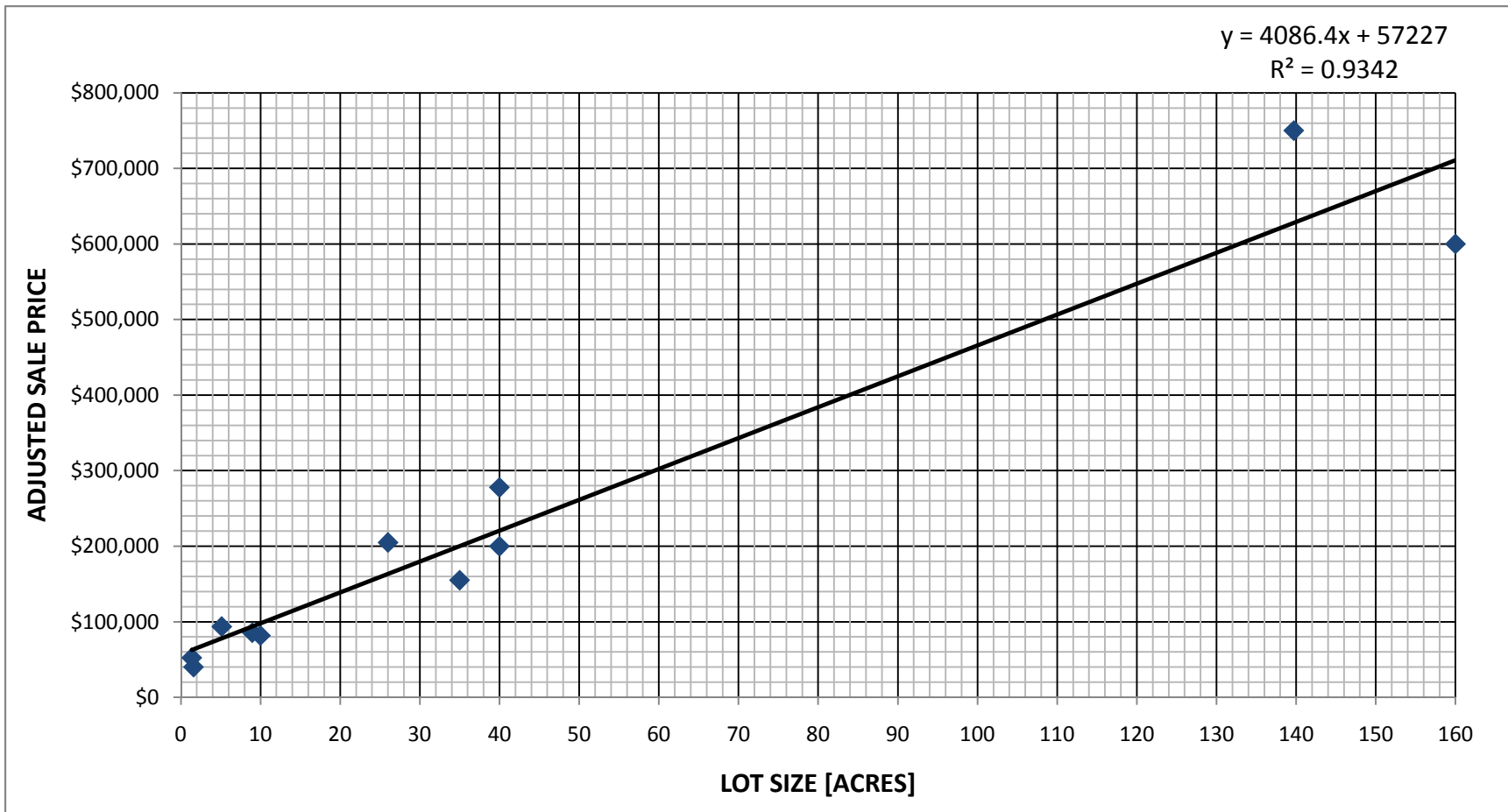

THE VALUE AND SIZE FROM THE FOLLOWING SALES WERE PLOTTED ON THIS GRAPH

**2011 REAPPRAISAL  
ECONOMIC AREA 8  
VACANT LAND**

**MEADOW/TREE LAND STUDY: GOOD ACCESS**

07/01/2006-06/30/2010

ACCOUNT NUMBER	SALE DATE	SALE PRICE	ADJUSTED SALE PRICE	ACRES	PARCEL NUMBER	LEGAL
R007700	11/25/2009	\$52,250	<b>\$52,250</b>	<b>1.38</b>	369523401003	1.053 ACRES IN W2SE4 SEC 23 50N3E (PARCEL 3 DOLEZAL TRACTS) #595420
R016273	12/04/2007	\$40,000	<b>\$40,000</b>	<b>1.60</b>	398500000011	1.6 ACRES IN LOTS 37,44 SEC 1 48N5W #580789
R014579	06/09/2010	\$93,750	<b>\$93,750</b>	<b>5.13</b>	404532000001	5.13 ACRES IN NE4NE4SW4, SE4NE4SW4, SW4NW4SE4. SEC 32 47N6W #598928
R012363	09/10/2007	\$85,500	<b>\$85,500</b>	<b>8.97</b>	405100000059	8.969 ACRES IN LOTS 1 & 2 SEC 36 47N3W #578987
R044320	02/02/2007	\$81,800	<b>\$81,800</b>	<b>10.00</b>	398700000041	E 10 AC OF SW4NW4 SEC 26 48N6W #572839
R008447	07/02/2007	\$205,000	<b>\$205,000</b>	<b>26.01</b>	369500000015	PART OF TRACT 41 SEC 23 50N3E 26.01 ACRES #576582
R045434	05/27/2009	\$155,000	<b>\$155,000</b>	<b>35.00</b>	318300000111	35 AC TRACT IN NE4 SEC 12 13S89W #590998
R015924	12/01/2009	\$277,800	<b>\$200,000</b>	<b>40.00</b>	291900000053	NE4SE4. SEC 27 11S89W 40 ACRES #595489 (TRACT 33 RAGGED MTN RESERVE)
R016333	02/02/2007	\$200,000	<b>\$277,800</b>	<b>40.00</b>	398700000042	SE4NW4. SEC 26 48N6W 40 AC #572838
R045207	03/27/2008	\$750,000	<b>\$750,000</b>	<b>139.71</b>	405300000120	139.709 AC IN SW4SW4. & W2SE4. SEC 33 47N2W #582975 #599142
R007236	01/19/2007	\$600,000	<b>\$600,000</b>	<b>160.00</b>	291723401037	SW4NW4.W2SW4. SEC 23 & NW4NW4. SEC

**MEADOW/TREE GOOD ACCESS: LEA 80070**

2011 REAPPRAISAL  
ECONOMIC AREA 8  
VACANT LAND

MEADOW/TREE LAND STUDY: FAIR-POOR ACCESS

07/01/2006-06/30/2010

MEADOW/TREE FAIR ACCESS: 80080  
MEADOW/TREE FAIR ACCESS MIXED: 80081  
MEADOW/TREE POOR ACCESS: 80090  
MEADOW/TREE POOR ACCESS MIXED: 80091  
\$3,669/ACRE

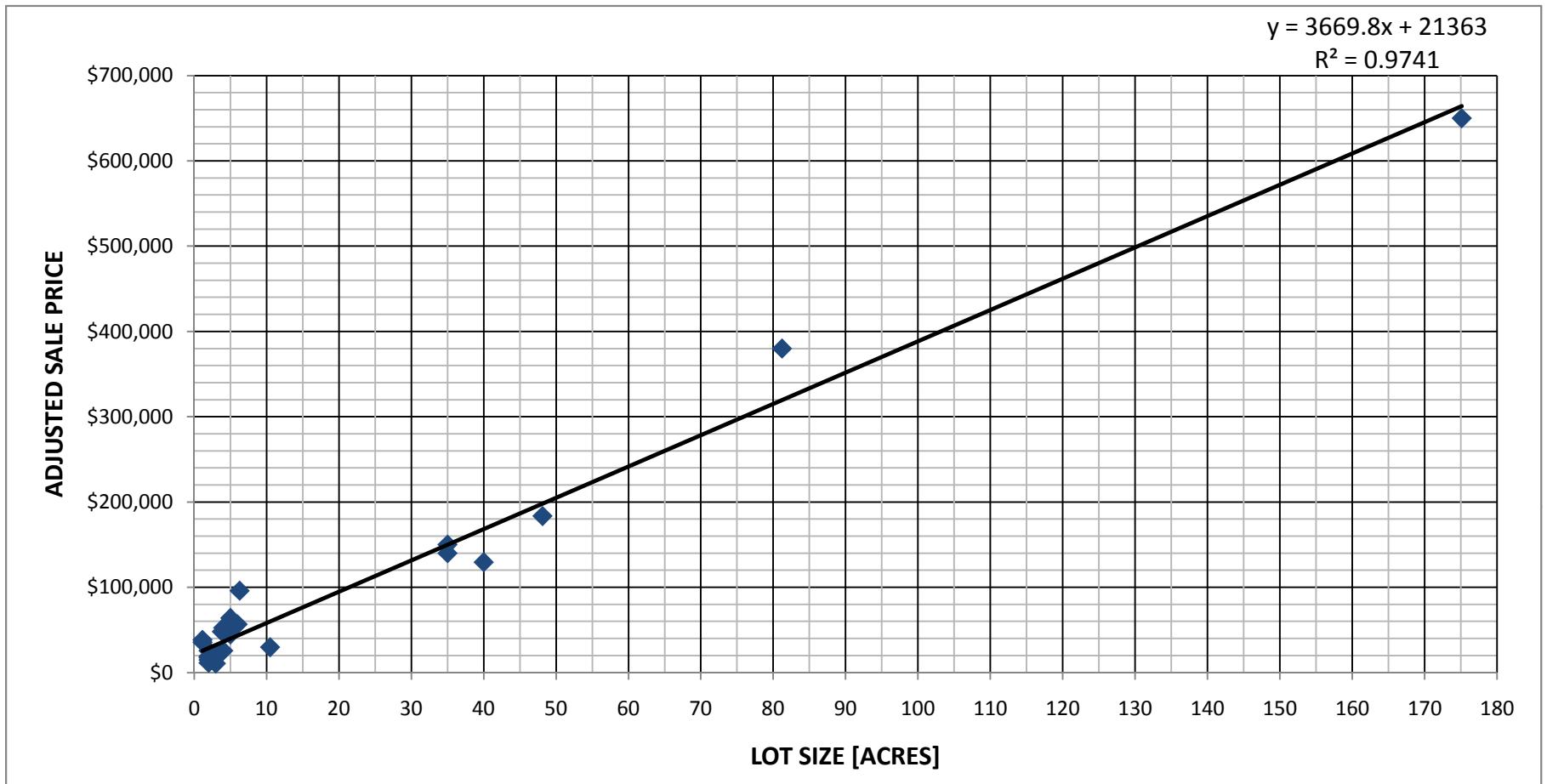

THE VALUE AND SIZE FROM THE FOLLOWING SALES WERE PLOTTED ON THIS GRAPH

**2011 REAPPRAISAL  
ECONOMIC AREA 8  
VACANT LAND**

**MEADOW/TREE LAND STUDY: FAIR-POOR ACCESS**

07/01/2006-06/30/2010

ACCOUNT NUMBER	SALE DATE	ADJUSTED SALE PRICE	ACRES	PARCEL NUMBER	LEGAL
R027631	08/02/2006	<b>\$38,400</b>	<b>1.16</b>	404532003009	LOT 9 EAGLES REST PHASE I #568265
R009434	08/15/2007	<b>\$35,520</b>	<b>1.17</b>	342706008009	LOT 5 SAWATCH VIEW SUBDIVISION TRACT A #577943
R027602	08/29/2006	<b>\$25,600</b>	<b>2.00</b>	405130003016	LOT 83 BLUE MESA SUBD UNIT 1 #568794
R016902	01/05/2007	<b>\$11,500</b>	<b>2.00</b>	405130002003	LOT 138 BLUE MESA SUBD 1 #572518
R016744	06/29/2007	<b>\$14,720</b>	<b>2.00</b>	405107002017	LOT 210 BLUE MESA SUBD 2 #576498
R016894	09/16/2008	<b>\$17,600</b>	<b>2.00</b>	405130003060	LOT 96 BLUE MESA SUBD 1 #586670
R011546	08/10/2007	<b>\$18,880</b>	<b>2.00</b>	405117002050	LOT 119 BLUE MESA SUBD 2 #577821
R011507	09/09/2009	<b>\$10,560</b>	<b>3.00</b>	405119001019	LOT 137 BLUE MESA SUBD 1 #593629
R044369	08/18/2007	<b>\$22,400</b>	<b>3.50</b>	405107004007	LOT 51 BLUE MESA SUBD UNIT 2 #578044
R027622	04/06/2007	<b>\$48,000</b>	<b>3.85</b>	404532004013	LOT 31 EAGLES REST SUB PHASE II &
R016606	10/31/2007	<b>\$25,600</b>	<b>4.00</b>	405117002013	LOT 40 BLUE MESA SUBD 2 #580779
R016805	09/22/2006	<b>\$52,480</b>	<b>4.00</b>	405118004020	LOT 277 & 278 BLUE MESA SUBD 2 #569968
R017159	10/16/2009	<b>\$44,740</b>	<b>5.00</b>	425105001003	LOT 6 SILVERJACK SUBD #594686
R017161	10/31/2006	<b>\$64,000</b>	<b>5.01</b>	425105001010	LOT 13 SILVERJACK SUBD #570718
R012378	08/21/2008	<b>\$56,500</b>	<b>6.00</b>	405108002023	LOTS 14 & 50 BLUE MESA SUBD UNIT 2 #586057
R042898	03/09/2010	<b>\$96,000</b>	<b>6.28</b>	404532003026	LOT 3 EAGLES REST PHASE 1 & LOTS 23-24 EAGLES REST PHASE 2 & 3
R016881	09/20/2007	<b>\$29,760</b>	<b>10.50</b>	405130003066	LOTS 72, 73, 76 & 77 BLUE MESA SUBD 1 #580781
R041490	10/12/2007	<b>\$150,000</b>	<b>35.00</b>	404900000143	35 AC (TRACT R-1B) IN N2 SEC 14 47N4W #579539
R044060	07/24/2006	<b>\$140,000</b>	<b>35.01</b>	350300000021	35.01 AC TRACT IN SW4SE4 & E2SE4SW4 SEC 13, & IN N2N2NW4NE4 SEC 24 51N6W #567782
R009485	08/30/2006	<b>\$129,500</b>	<b>40.00</b>	351900000063	SW4NE4. SEC 29 51N2E 40 AC ORIGINAL SURVEY #568644
R009517	06/16/2008	<b>\$183,500</b>	<b>48.13</b>	351900000144	NE4NW4, & LOT 1 SEC 20 51N2E
R014781	07/21/2006	<b>\$380,000</b>	<b>81.21</b>	325300000018	W2SW4. SEC 17 14S87W #567269
R015925	12/01/2008	<b>\$650,000</b>	<b>175.12</b>	298900000041	SW4. & SOUTH 15.123 AC OF THE NW4 SEC 32 12S89W #587868